

Components – Laerdal SimPad / Manikin

SIMPAD SYSTEM INCLUDES:



SimPad



Link Box



Li-Ion Battery



AC adapter x 2



Manikin Adapter Cable



Manikin Strap



Wrist Strap



USB Cable



SimPad Sleeve

MANIKIN



Technical Set Up and Shutdown Checklist

Laerdal SimPad



Collect all components for the SimPad set up as per the SimPad Components Guide above.

1. Connect the Link Box to the manikin:
 - a) Connect the Link Box to the manikin via the manikin cable (Ensuring that you match the stickers stating “this side up”).
 - b) Connect charged Li-Ion battery to the Link Box. (best practice would be to leave it connected permanently)
 - c) If desirable, connect a power adaptor to the Link Box. (But not necessary as a charged Li-Ion Battery has 3 – 4 hours operating time. You will get advance warning once battery is low).
 - d) Use the included manikin strap to attach the Link Box and battery to the manikin.

2. Turn on the Link Box and SimPad
 - a) Turn on both units by pressing the ON / OFF button marked with the power sign for at least half a second.
 - b) Release the button when the LED starts blinking green.
 - c) Ensure the Link Box is turned on and showing a solid green light (functioning correctly).
 - d) When the Link Box is ready, the ON light will turn steady green.
 - e) Check that the SimPad is ready; it will make a ‘boot up’ sound and will get to the default screen. See figure 1.
 - f) Follow the instructions on the display to select preferences.

3. Connection between the SimPad and Link Box
 - a) Connection to SimPad is indicated on the Link Box with a blue light in the Wi-Fi LED.
 - b) Connection to the Link Box is indicated in the upper right corner of SimPad’s screen with a Manikin symbol.

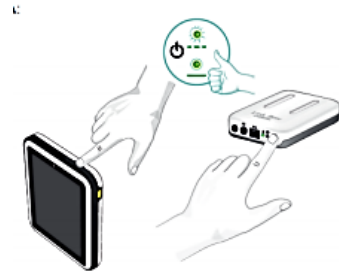

SimPad is the new remote control for your medical training simulator.
Control simulation sessions directly from the touch screen by simply tapping the icons.



Starting applications takes some seconds.

Figure 1

4. Shutdown Checklist

- a) Close any running scenario.
- b) Return the SimPad to its original main menu screen as in figure 1.
- c) Power off the SimPad pressing ON / OFF button marked for at least half a second. In the option screen that comes up, select Simpad and Link Box to shut down both. Alternatively shut them individually pressing ON /OFF button on the Link Box.
- d) Return to the storage area / recharge rack.

NOTE:

- Use only on clean surface. Do not immerse any part of the SimPad, Link Box, Li-Ion battery pack or Manikin in fluid.
- Avoid felt tip markers, ink pens, acetone, iodine, or other staining products and avoid placing the manikin on newsprint or inked lines of any kind.

Laerdal SimPad After-Use Care

For all equipment, the after-use care should be completed at the end of each session to ensure longevity. During the after-use care, general inspection should be conducted for any faults or wear and reported, repaired or replaced at this time.

The following preventive measures are essential to ensure longevity of the simulation equipment.

Maintenance after each Simulation Session: Mega Code Kid / SimJunior

1. Wear gloves during cleaning and maintenance procedures.
2. Power off all components.
3. Return manikin to their original condition.
4. Remove clothing immediately from the manikin / linen if wet during scenario. **(No water or fluid should ever get inside of the manikin)**
5. If the IM / IV / IO System have been used, remove the IM/ IV / IO fluids and empty the fluid drain reservoir (right leg / right arm. Re-tape or redress the IM/ IV / IO site as needed to stop leakage. Air dry all parts.
6. Remove tape residue with a moist cloth or rubbing alcohol.
7. Wipe the skin with a moist cloth. Use approved cleaning solution only to remove marks or residue.
 - a. If necessary use REMOVE wipe to remove tape residue and immediately wiped with light moist cloth to remove any remains.
8. Remove or replace any modules that are consumed or damaged.
9. Replace any specific disposable parts which have been used during the session
10. Replace cables or connectors showing visible damage.

Mankin skin will benefit from a light application of talcum powder to remove 'stickness' and improve feel.

Maintenance after each simulation session: SimPad

1. Unplug the Sim Pad / Link Box from communication lines, mains power outlet or any power source before cleaning or polishing.
2. Do not use liquid cleaners or aerosol cleaners.
3. Use a lint-free cloth to lightly clean the exterior.
4. Recharge all components in correct charging storage racks in store area.



• Connect SimPad to one of the AC adapters and plug into a wall outlet. The battery is fully charged when the LED on SimPad shows a steady yellow light.



• Connect the Li-Ion battery to one of the DC adapters and plug into a wall outlet. The battery is fully charged when the LED on the battery shows a steady green light.